

Ceramic beads, spacers and tubes

Greenway Electronic Products, *the* single source for hardware components for the Electronics industry are pleased to announce our latest ceramic product range from **Cerabead**

Detailed below is our standard bead range ideally suited to high temperature applications such as standing off resistors and insulating wires etc., providing a quality product at competitive prices, with exact equivalents to other popular manufacturers.

We are also able to offer many other styles of bead as well as other ceramic products and can offer a full custom service. Please call for a quotation.

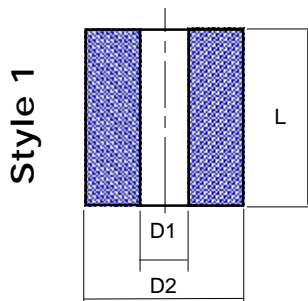

Part Number	D1	D2	L
219-001 (304-496/54-3557-0)	2.0	4.0	6.0
219-002 (304-497/54-3933-0)	1.3	4.5	8.0
219-003 (304-498/54-3933-1)	1.3	4.5	10.0

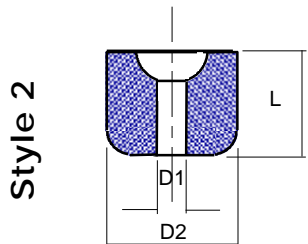

Part Number	D1	D2	L
218-001 (304-493/54-0604-0)	1.0	3.0	3.0
218-002 (304-495/54-0605-0)	1.8	4.5	4.5
218-003 (304-494/540604-1)	1.0	3.0	5.0
218-004	3.5	6.0	5.5

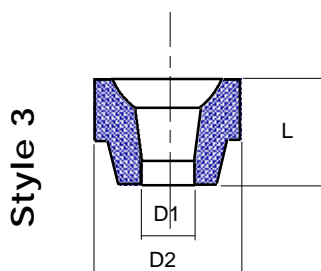

Part Number	D1	D2	L
217-001 (304-492/54-0519-0)	2.1	5.0	5.0
217-002	2.7	6.0	6.5
217-003	3.5	7.0	7.0

All dimensions in mm Material: Steatite C220 ceramic - IEC672-3

